



Beaconsfield, NSW

92 Victoria Street

2
BED

1
BATH

1
CAR

RobertAllan
Property

This 2 bedroom, full brick attached terrace enjoys an Easterly aspect and is located within close proximity to Green Square Train Station, Erskineville, Newtown, Redfern and the CBD.

The property requires renovations or you could knock it down and rebuild. Features include: 2 bedrooms, high ceilings, air-conditioning units, open plan lounge with adjoining gas eat-in kitchen and external laundry.

There is rear lane access for parking.

- Land size: 120 square metres (approx)
- Zoning: R1 General Residential (Sydney City Council)
- Council: \$345.91pq
- Water: \$285.19pq

SOLD

Council Rates: \$346/qtr (approx)

Contact: Robert Micallef
0418 967 717
Allan Micallef
0410 689 003

Type: Terrace

Sold Date: 09/05/2019

Land: 120m2

<https://www.robertallanproperty.com.au>

Inspect: Wednesday & Saturday 12:00 – 12:45pm

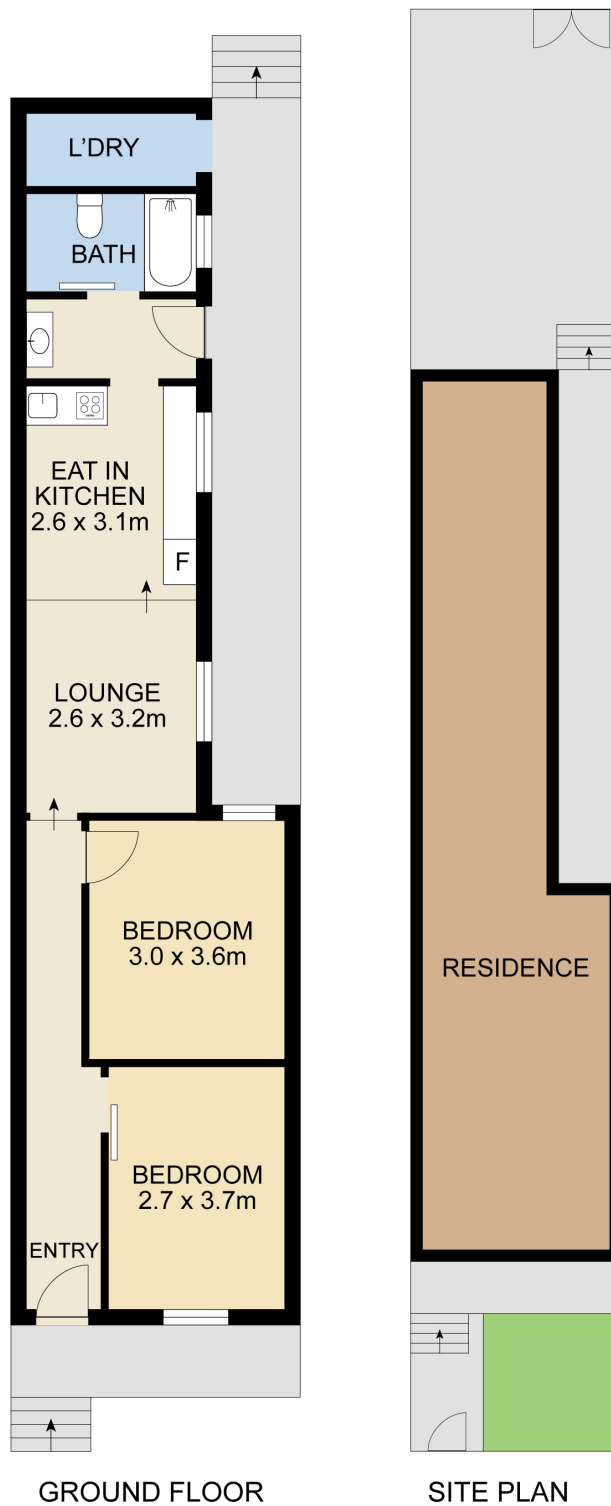

GROUND FLOOR

SITE PLAN



Scale in metres. Indicative only. Dimensions are approximate. All information contained herein is gathered from sources we believe to be reliable. However we cannot guarantee its accuracy and interested persons should rely on their own enquiries.

92 Victoria Street, Beaconsfield

Plans shown are only indicative of layout. Dimensions are approximate.

Beaconsfield, NSW
92 Victoria Street