



<p>Rosebery, NSW 77 Dalmeny Avenue</p>	<p>3 BED</p>	<p>1 BATH</p>	<p>4 CAR</p>	<p>RobertAllan Property</p>
---	-------------------------	--------------------------	-------------------------	--

This double brick and tile rendered freestanding home enjoys an elevated position and is on 695 square metres of land (approx).

Dimensions are: 15.24m x 45.72m.

Features include:

- Central entry hallway
- 3 bedrooms
- High ceilings, polished timber floorboards throughout
- Excellent security, Separate lounge and dining rooms
- Original bathroom, eat-in timber kitchen
- Internal laundry and 2nd WC.

The large enclosed verandah has been converted into a separate family room, which opens out onto the East-facing yard. For the wine connoisseur, there is a cantina below where the temperature is very cool. The wide side driveway leads to a lock- up garage (Potential granny flat

conversion STCA)

This property offers potential to further enhance both inside and out.

Located only 7.5 k/m's to CBD, close to Australian Golf Course,
Rosebery's cafes and restaurants, parks, schools and the Eastern
Distributor.

- Council Rates: \$2,032.01pa

- Water Rates \$198.89pq

Auction: on Site,

SOLD

Council Rates: \$2,032/year (approx)

Contact: Robert Micallef
0418 967 717
Allan Micallef
0410 689 003

Type: House

Sold Date: 08/11/2019

Land: 695m2

<https://www.robertainproperty.com.au>



GROUND FLOOR

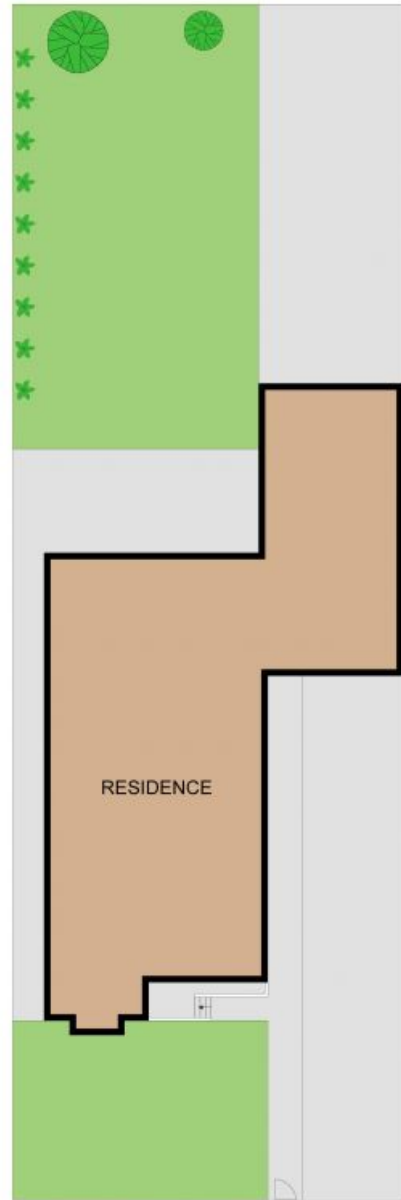

SITE PLAN



Scale in metres. Indicative only. Dimensions are approximate. All information contained herein is gathered from sources we believe to be reliable. However we cannot guarantee its accuracy and interested persons should rely on their own enquiries.

77 Dalmeny Avenue, Rosebery

Plans shown are only indicative of layout. Dimensions are approximate.

Rosebery, NSW
77 Dalmeny Avenue